

TOP VIEW ITEM # 13

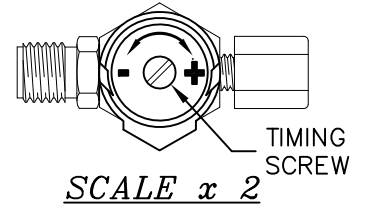

TIMING IS ADJUSTABLE FROM 5 TO 60 SECONDS AND IS ACCOMPLISHED BY ROTATING TIMING SCREW. TURNING THE SCREW CLOCKWISE INCREASES WHILE COUNTERCLOCKWISE DECREASES TIMING.

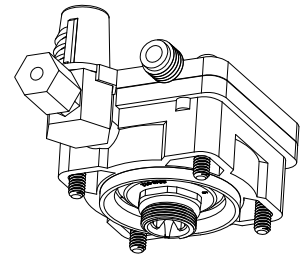

**NOTE:**  
REMOVE ASSEMBLY (18)  
FOR PLASTIC BODY INSTALL

1	2563-020-002	AIR-CONTROL METERING ASSEMBLY
2	0116-012-000	8-32 x 1-1/4" LG PHILLIPS ROUND HEAD
3	0331-003-000	#8 LOCKWASHER
4	2563-020-001	METERING MOTOR ASSEMBLY
5	2563-024-000	METERING COVER PLATE
6	2563-023-000	METERING AIR DIAPHRAM SPRING
7	2563-022-000	METERING AIR DIAPHRAM
8	2563-021-001	MAGNET CUP ASSEMBLY
9	2563-003-000	ACTUATOR SPRING
10	2563-001-000	MOTOR HOUSING
11	0401-026-000	O-RING
12	2563-002-199	SEPERATOR CUP
13	2564-000-001	TIMER ASSEMBLY
14	2560-015-001	SEAT ASSEMBLY
15	2563-008-000	PILOT ORIFACE PLATE SPRING
16	2563-019-001	PILOT ORIFACE PLATE ASSEMBLY
17	2563-010-001	WATER DIAPHRAM ASSEMBLY
18	2580-000-001	SEAT ASSEMBLY
19	2580-000-000	SEAT
20	0401-014-000	SEAT O-RING
ITEM	PART NUMBER	DESCRIPTION

**ACORN ENGINEERING COMPANY**  
P.O. BOX 3527 INDUSTRY, CA. 91744  
(626) 336-4561 FAX (626) 961-2200

TITLE **AIR-CONTROL METERING SERVOMOTOR ASSEMBLY**

MANUFACTURE DATE  
**JANUARY 1984**  
**TO PRESENT**

DATE ISSUED  
**04/14/09**  
DATE REVISED  
**02/03/11**

DRAWING NUMBER  
**9955-000-003**